

## LE-2SS Liquid Eliminator



The Welker® LE-2SS Liquid Eliminator is designed to protect analyzers from damage and contamination by removing liquids from gas samples.

### Features

- Integrated liquid and sediment filtration
- Liquid-eliminating chamber
- Self-draining design
- Optional Knock-Out Probe™ for pipeline mount
- Stainless steel construction

### Benefits

- Optimizes profitability by protecting sensitive equipment from liquid damage
- Quick and easy installation
- Simple maintenance



Optional Knock-Out Probe™

Product and/or components are manufactured under US Patent: 6,764,536

## SPECIFICATIONS

### LE-2SS LIQUID ELIMINATOR

#### LE-2SS

Materials of Construction	304 Stainless Steel, 316/316L Stainless Steel, Copolymer Filter Element, Teflon®, Viton®
Inlet Connection	¼" FNPT
Outlet Connection	¼" FNPT
Pipeline Connection	¾" MNPT (Knock-Out Probe™ Option)
Insertion Length	8" (Knock-Out Probe™ Option)
Operating Pressure	1440 psig @ -20 °F to 100 °F

# STANDARD OPTIONS

LE-2SS LIQUID ELIMINATOR

## LE2SS FOR STAND-ALONE LIQUID ELIMINATOR

WITH OPTIONAL KNOCK-OUT PROBE™

	BODY MATERIAL	PIPELINE CONNECTION	INSERTION LENGTH			OUTLET CONNECTION
LE2	<b>SS</b> KO	<b>B</b>	<b>0</b>	<b>8</b>	<b>0</b>	<b>A</b>
	316/316L Stainless Steel	¾" MNPT	8"			¼" FNPT

For custom options, choose **Plus Welker™**.



Customer Inspired. Welker Manufactured.

Collaborate with us to create a custom product unique to your application.

## DIMENSIONS

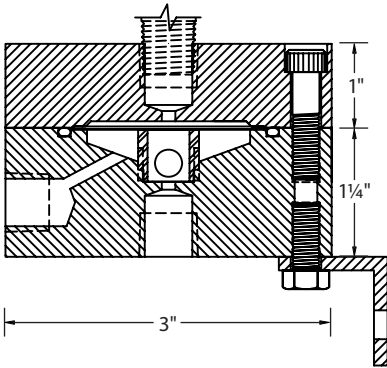

LE-2SS

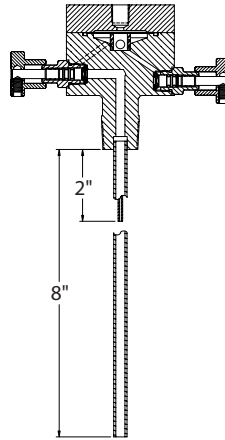

LE-2SS  
With Knock-Out Probe™

Weight and/or dimensions are approximate.  
Specifications subject to change without notice.



Nordaaesdalen 25, 5235 Raadal, Norway  
Contact us: Name: Per Arne Eriksen  
Jan Arle Netland

Phone: +47 95888526  
+47 92831990

Email: per@fiskal.no  
jan@fiskal.no